

# ABRU BOX SECTION REFORM LADDER

## Assembly and Operating Instructions

### 1. Stabiliser Attachment

1.1 The supplied Stabiliser Assembly comprises the following components:-

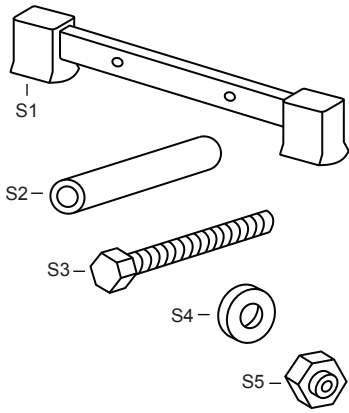

- |                                       |           |
|---------------------------------------|-----------|
| <b>S1 Straight Bar Stabiliser</b>     | <b>x1</b> |
| <b>S2 Cylindrical Spacer Sleeves</b>  | <b>x2</b> |
| <b>S3 M8 Hex Head Bolts</b>           | <b>x2</b> |
| <b>S4 M8 Plain Washers</b>            | <b>x4</b> |
| <b>S5 M8 Hex 'Nyloc' Locking Nuts</b> | <b>x2</b> |

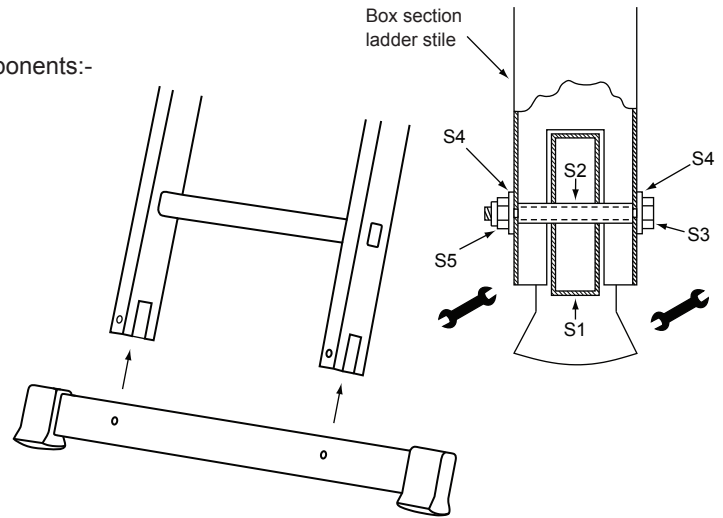

- 1.2 Insert and centralise the Spacer Sleeves (S2) within the two holes in the Stabiliser (S1).
- 1.3 Locate the Stabiliser / Spacer Sleeve pre-assembly (S1 / S2) within the open lower ends of the Base / Rear ladder section stiles ensuring that the Stabiliser feet are facing 'downward', the Stabiliser is fully located within the two stile slots and both Spacer Sleeves are concentrically aligned with the two stile holes.
- 1.4 Fit one Washer (S4) onto each Bolt (S3) and then pass both Bolts through the stile holes and Spacer Sleeves.
- 1.5 Fit one further Washer (S4) onto each Bolt (S3) and then secure both Bolts with the Nuts (S5) taking care not to over-tighten.

### 2. 'Stepladder' Mode Deployment

- 2.1 Stand and support the closed product in a vertical orientation and then slightly lift and pull outward the Mid / Fly ladder section assembly just sufficient that the Mid / Front ladder section rung hooks disengage from and clear the Base / Rear ladder bottom rung.
- 2.2 Continue to pull the Mid / Fly ladder section assembly outward until the side webbing straps are taut and then place all four ladder feet on a flat / level standing surface (also refer to safety label on the product).
- 2.3 Check and ensure that both support bosses at the top of the Mid / Front ladder stiles are fully engaged within the respective cradle brackets at the top of the Base / Rear ladder stiles (also refer to safety label on the product).
- 2.4 Lift and release the lower end of the metal side stay located on the inside of the Mid / Front ladder section left-hand stile, raise the stay and engage the retaining pin within the slot of the securing bracket located on the inside of the Base / Rear ladder section left-hand stile (also refer to safety label on the product).
- 2.5 Re-closure of the product is achieved by the reversal of the above procedure.

### 3. 'Reform/Freestanding Extension Ladder' Mode Deployment (triple only)

- 3.1 Follow above steps 2.1 to 2.4 and deploy the product in the 'Stepladder' mode.
- 3.2 Press the lower tab of the lock / release mechanism located on the outside of the Fly / Front ladder section right-hand stile and rotate fully to the 'release' position (also refer to safety label on the product).
- 3.3 Slightly lift and pull outward the Fly / Front ladder section just sufficient that the Fly / Front ladder section rung hooks disengage from and clear the Mid / Front ladder bottom rung.
- 3.4 Raise the Fly / Front ladder section to the desired extended ladder length and relocate both Fly / Front ladder rung hooks onto the required Mid / Front ladder section rung ensuring that both rung hooks are fully engaged with the rung (also refer to safety label on the product).
- 3.5 Press the upper tab of the lock / release mechanism and rotate fully to the 'lock' position (also refer to safety label on the product).
- 3.6 Retraction / re-closure of the product are achieved by the reversal of the above procedure.

### 4. 'Extension Ladder' Mode Deployment

- 4.1 Follow above steps 3.2 to 3.5 to extend the Fly / Front ladder section to the desired position.
- 4.2 Slightly lift and pull outward the Mid / Front ladder section just sufficient that the Mid / Front ladder section rung hooks disengage from and clear the Base / Rear ladder bottom rung.
- 4.3 Raise the Mid / Front ladder section to the desired extended ladder length and relocate both Mid / Front ladder rung hooks onto the required Base / Rear ladder section rung ensuring that both rung hooks are fully engaged with the rung.
- 4.4 Retraction of the product is achieved by the reversal of the above procedure.